

(2) Wall-Rack {U-Strut} Corrals
{Straight} Racks
{8-Bike} Capacity

Wall-Rack {U-Strut} Corral
{Straight} Racks
{4-Bike} Capacity

{Plain} Galvanized Steel
{Standard}
{Silver} Powder Coated Steel
{Optional}

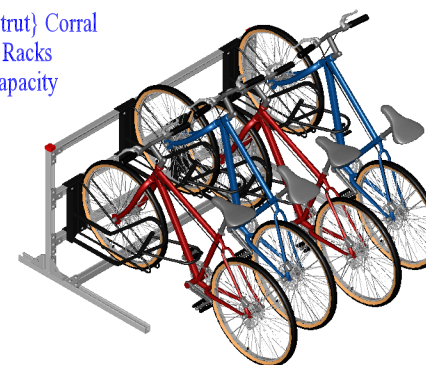

FRAME VIEW
SCALE = 4:1

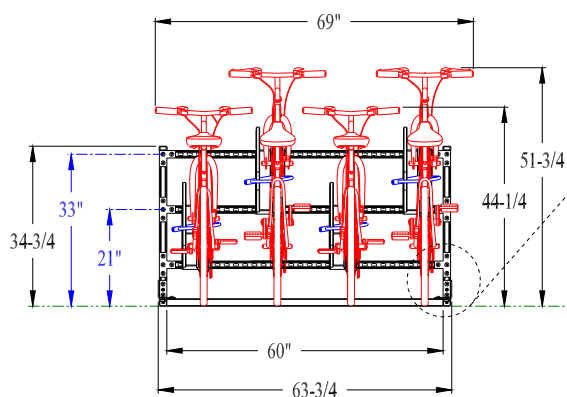
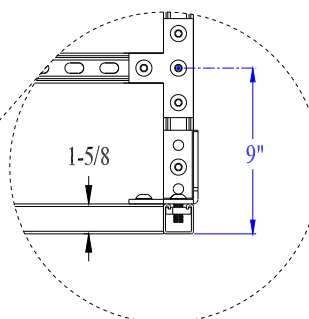

FRONT VIEW

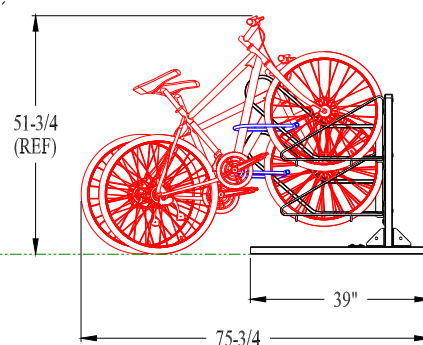

SIDE VIEW

THE WALL-RACK CORRAL (H-STRUT) FRAME CONSTRUCTION IS (2) 1-5/8 X 1-5/8 GALVANIZED H-STRUT CHANNEL LEGS, (4) STRINGERS 1-5/8 X 1-5/8 GALVANIZED U-STRUT & (1) MOUNTING CHANNELS 1-5/8 X 1-5/8 GALVANIZED U-STRUT WITH FASTENING HARDWARE

PLASTIC CAPS ARE PLACED IN THE OPEN STRUT ENDS

3/8" Ø CRS STEEL BLACK POWDER COATED WALL-RACKS

3/4" FORMED SQUARE TUBING & 1/8" FORMED STEEL PLATE LOCK BAR MOUNTING FRAME {POWDER COATED}

STAINLESS STEEL WALL-RACKS ALSO AVAILABLE

SHIPPING WEIGHT IS 221 LBS. OR 100.2 KG. PER ASSEMBLY

SHEET 1 OF 1	A	RELEASE FOR QUOTE		01/07/19
	REV	DESCRIPTION		DATE
TOLERANCES UNLESS OTHERWISE SPECIFIED: +/-	WALL-RACK {CORRAL} ASSEMBLY {STRAIGHT}			
			Cycle Safe 5211 CASCADE ROAD - SUITE 210 GRAND RAPIDS, MI 49546 www.cyclesafe.com	
	BOB SLYH	01/07/19		
	CHECKED	DATE		
	APPROVED	DATE		
.X .030	DATE			
.XX .010				
.XXX .005				
ANGLE 1/2°				
	REV D	{4-BIKE} H-STRUT (1-SIDE) ASSEMBLY		REV A